

Public Open House #2

Rodney Street Reconstruction Phase II 9th Avenue to Helena Avenue

May 26, 2021

Presented by
City of Helena
and
KLJ Engineering LLC



Staff Introduction

➤ Matt Culpo

City of Helena Project
Manager

➤ Dan Richardson

KLJ – Consultant Project Manager

➤ Jacob Garcin

City of Helena Public
Information Officer

➤ Laura Langdon

KLJ – Consultant Public
Information Officer

Project Structure: Phased Approach

- **Phase 1** - Broadway to 9th Avenue (construction spring/summer of 2021)
Status: Construction to start this year
- **Phase 2** - 9th Avenue to Helena Avenue (public meetings 2021, construction 2022)
Status: Design in progress
- **Phase 3** - : Helena Avenue to Lyndale Avenue and Broadway to Division Street. (TBD)
Status: TBD

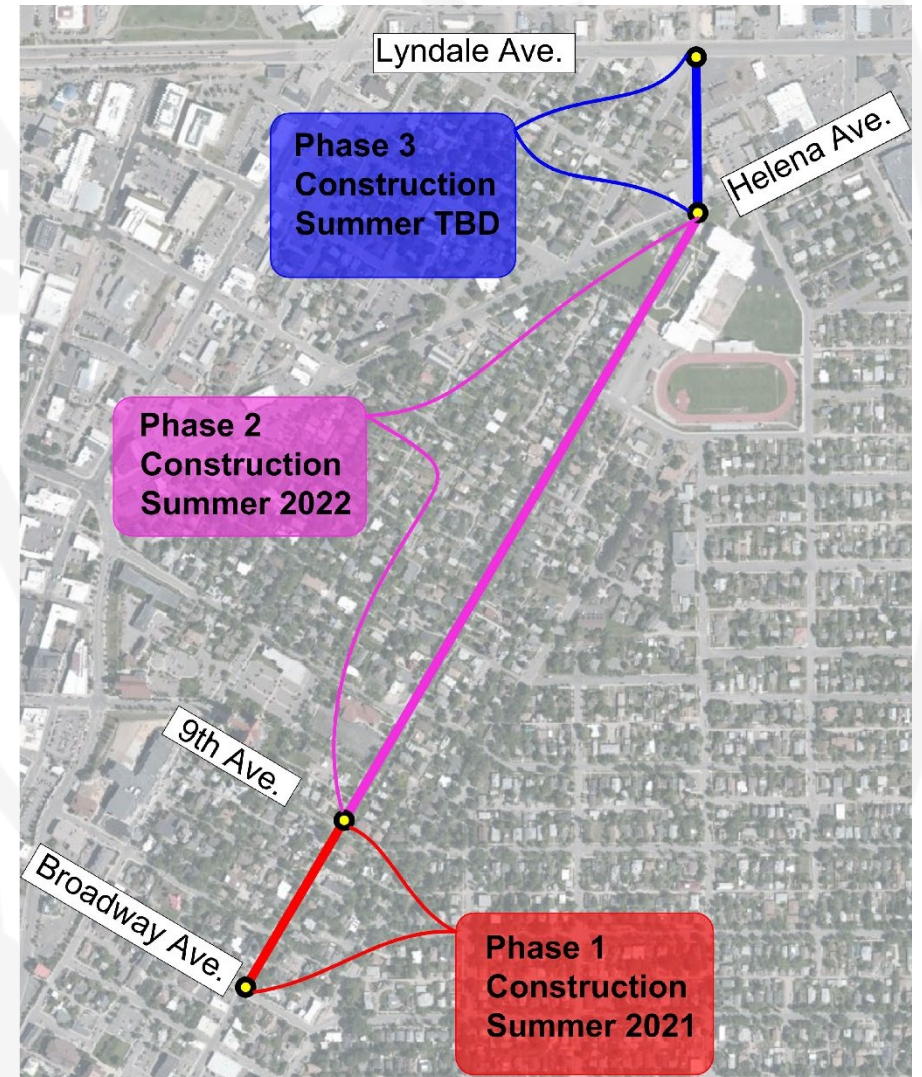

Scope of Design

RODNEY STREET

PHASE II RECONSTRUCTION
(LOOKING NORTH)

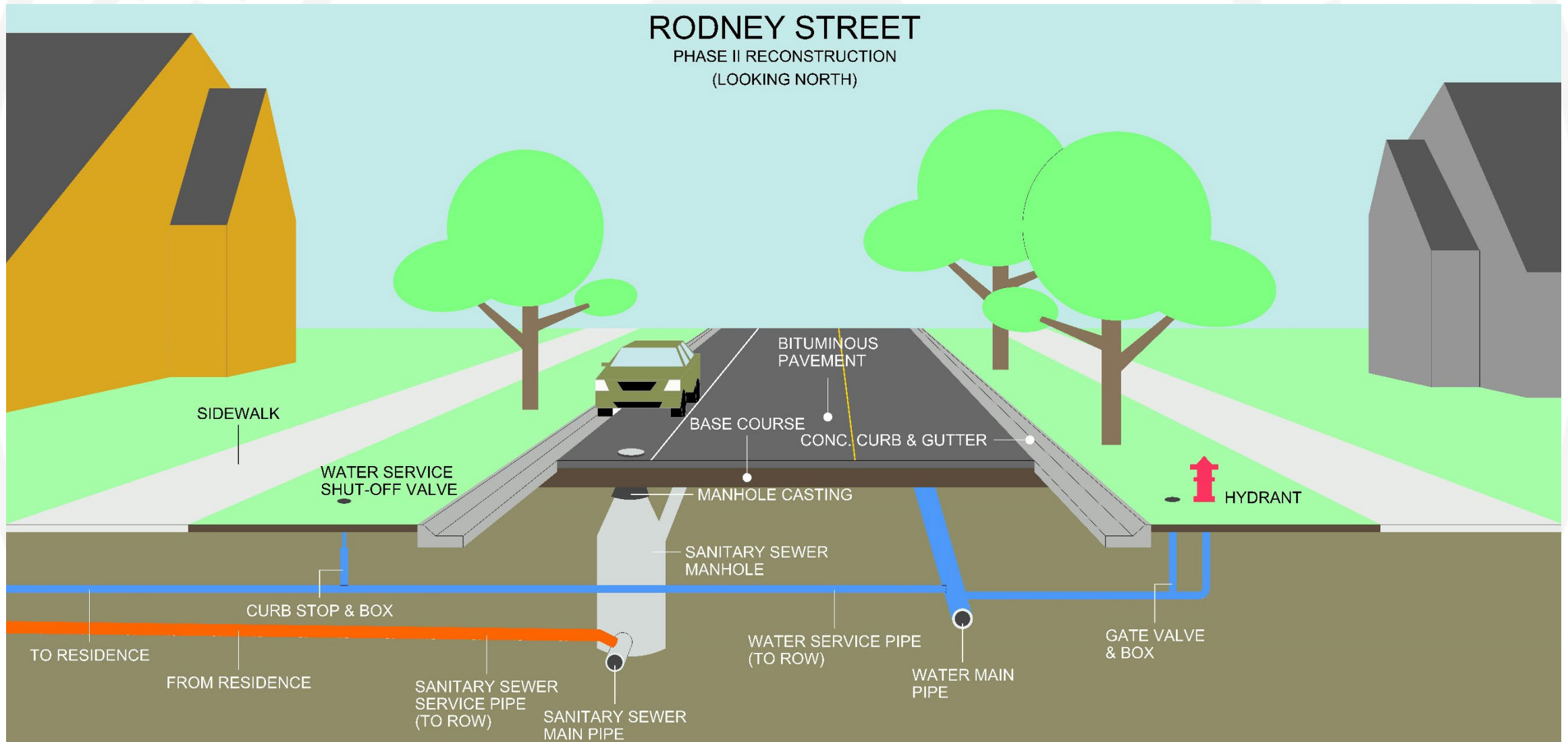

Scope of Design

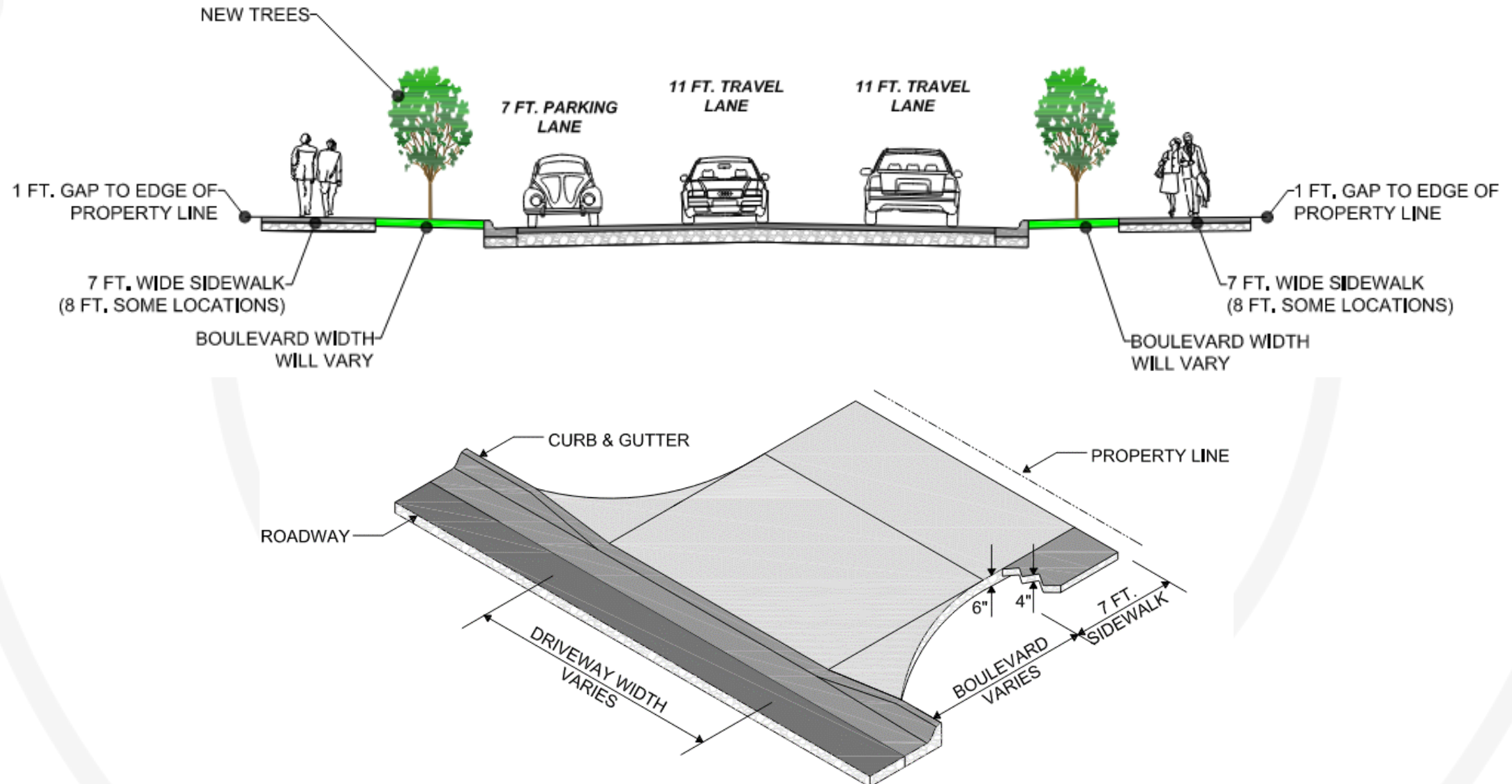

Tree Replacement

> Prairie Expedition “Lewis and Clark” American Elm

Young



Summer Foliage



> Bur Oak

Young



Summer Foliage



Landscaping Plans

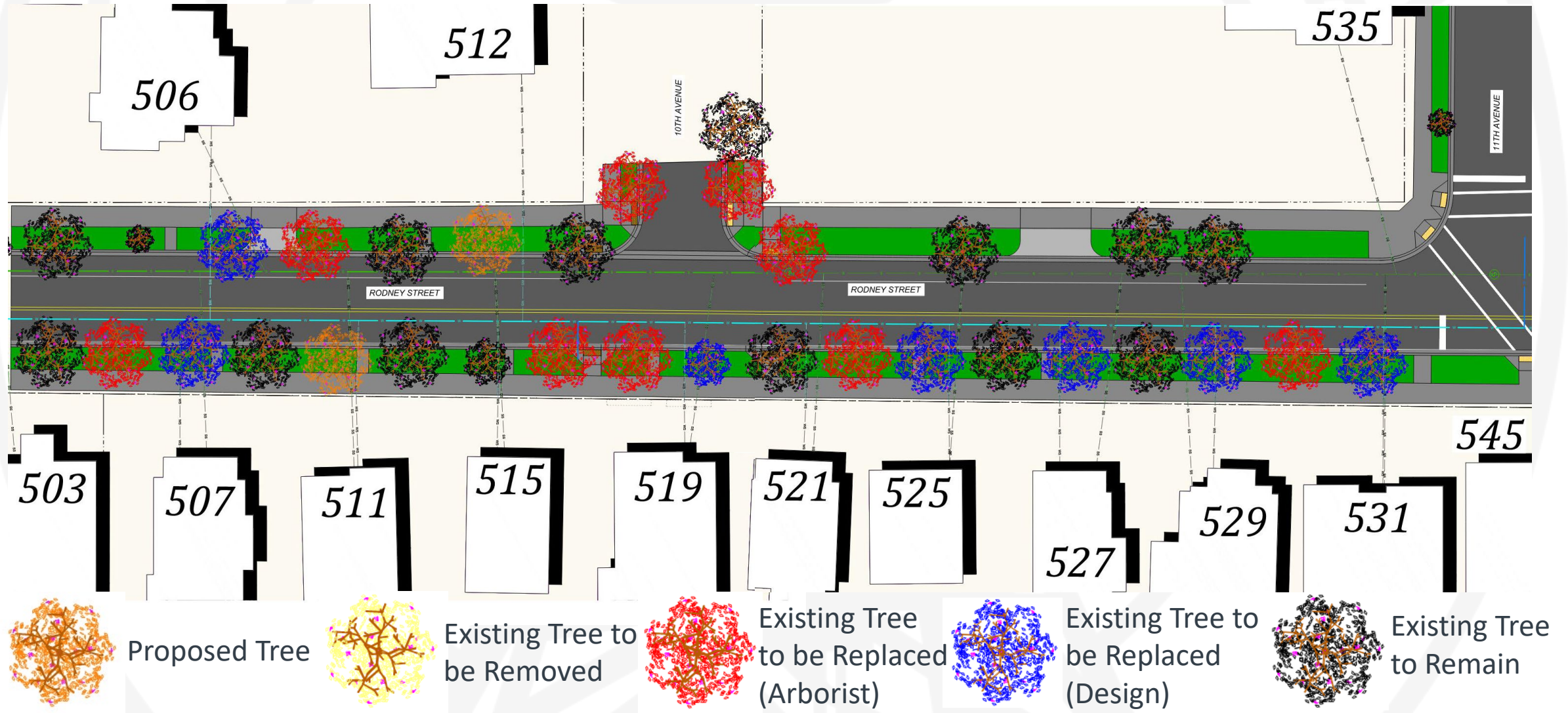

Landscaping Plans

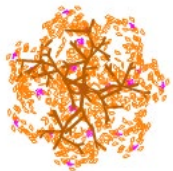
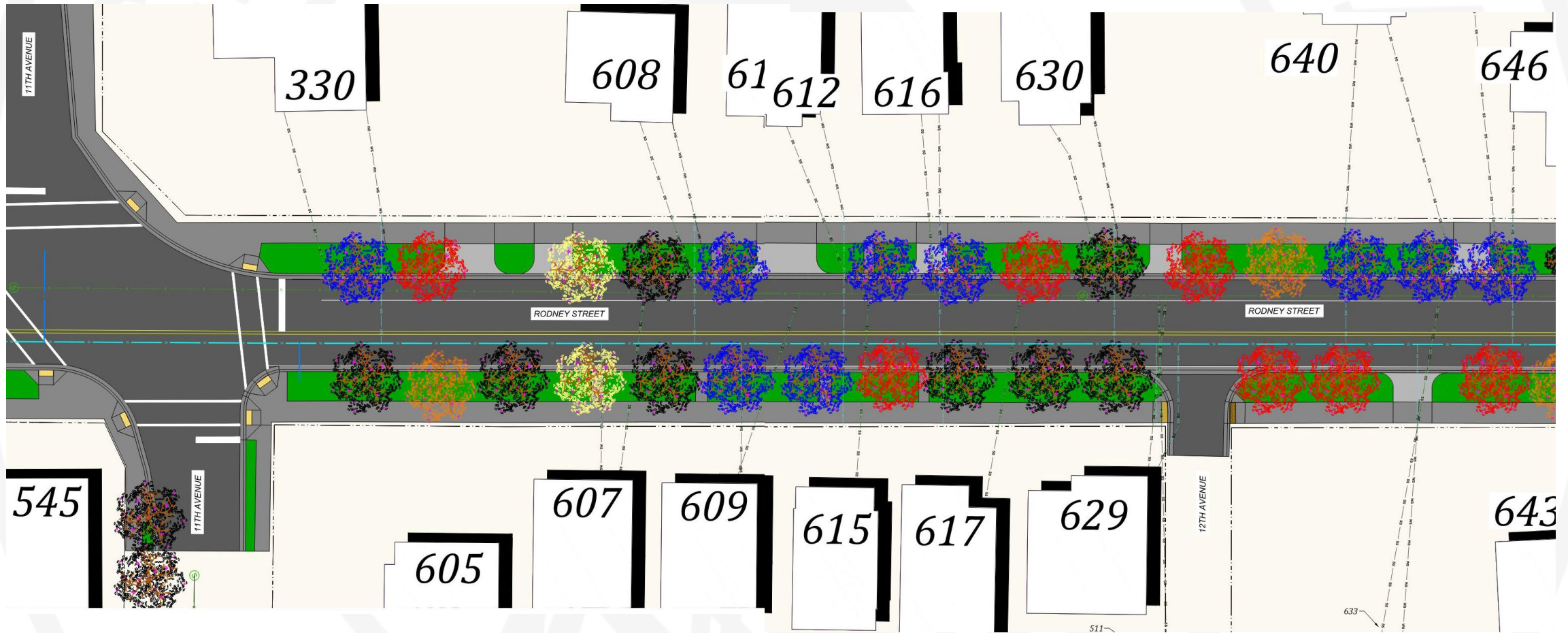

Proposed Tree

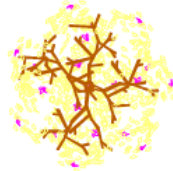

Existing Tree to
be Removed

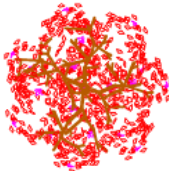

Existing Tree
to be Replaced
(Arborist)

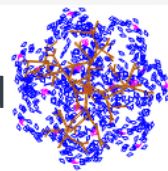

Existing Tree to
be Replaced
(Design)

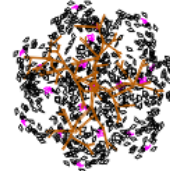

Existing Tree
to Remain

Landscaping Plans

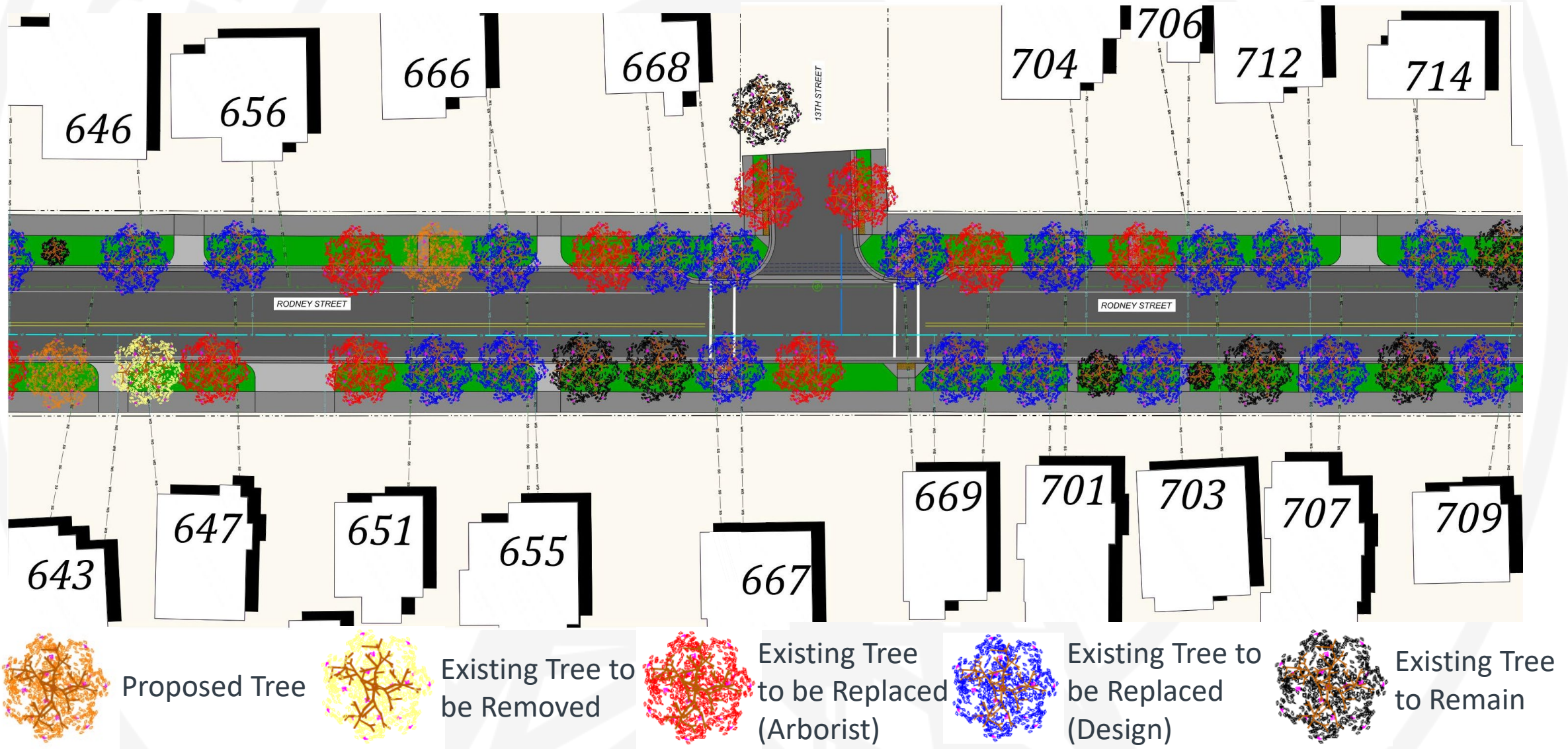

This aerial map shows a residential street with house numbers and tree locations. The street is labeled "RODNEY STREET" in two locations. The houses are numbered as follows:

- Top row (left to right): 716, 718, 800, 802, 810, 814, 816, 822, 824, 826.
- Bottom row (left to right): 709, 711, 717, 801, 811, 813, 815, 821, 825.

A vertical street labeled "14TH STREET" runs through the bottom row of houses. The map shows a green grassy area with numerous trees, some of which are highlighted in red and blue. The trees are located along the street and in the yards of the houses. The map also shows a sidewalk and a road with lane markings.



Landscaping Plans

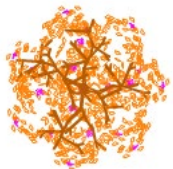

Proposed Tree



Existing Tree to
be Removed

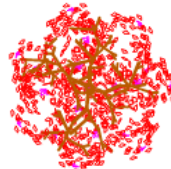

Existing Tree
to be Replaced
(Arborist)

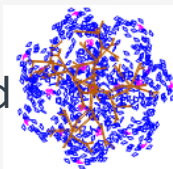

Existing Tree to
be Replaced
(Design)

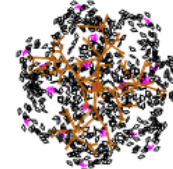

Existing Tree
to Remain

Landscaping Plans

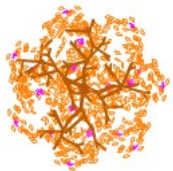
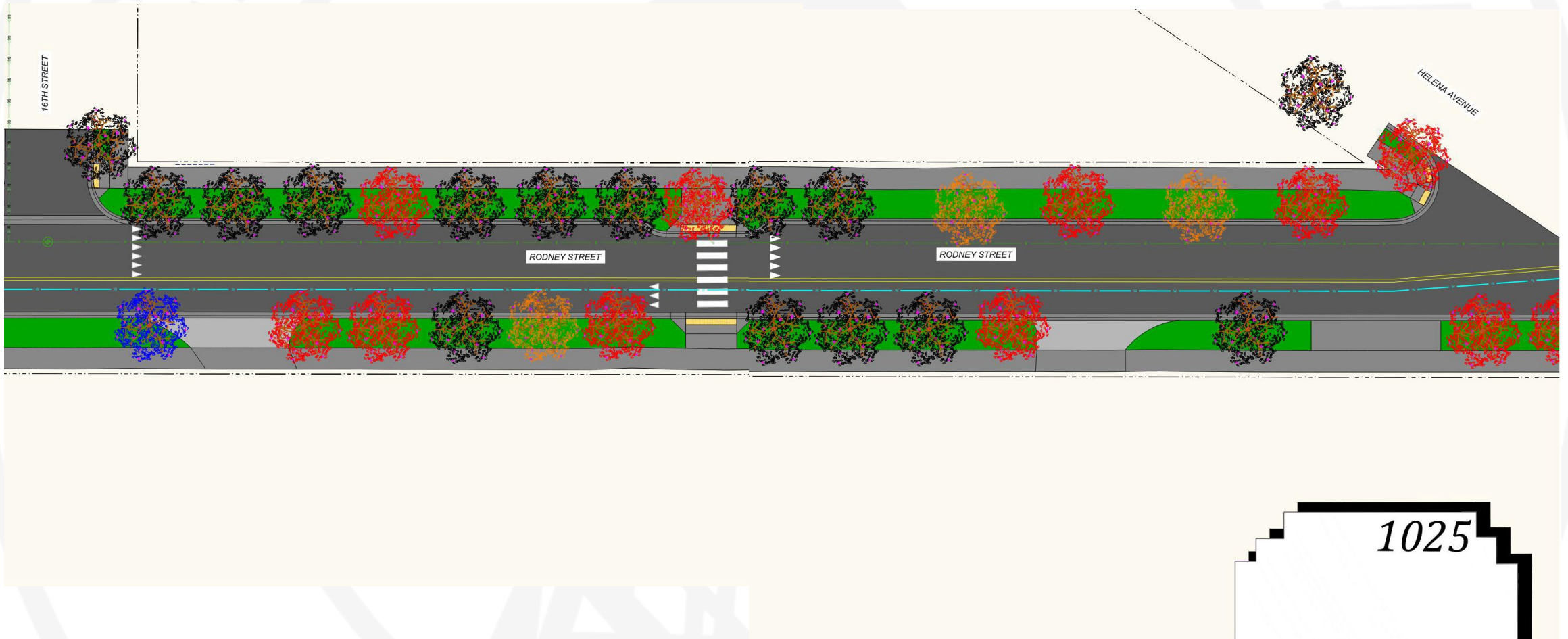

Proposed Tree

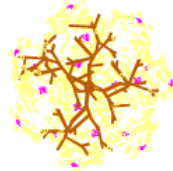

Existing Tree to
be Removed

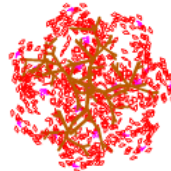

Existing Tree
to be Replaced
(Arborist)

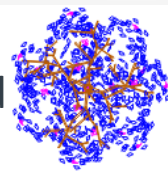

Existing Tree to
be Replaced
(Design)

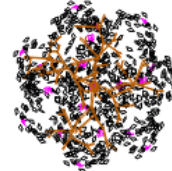

Existing Tree
to Remain

Design Plans

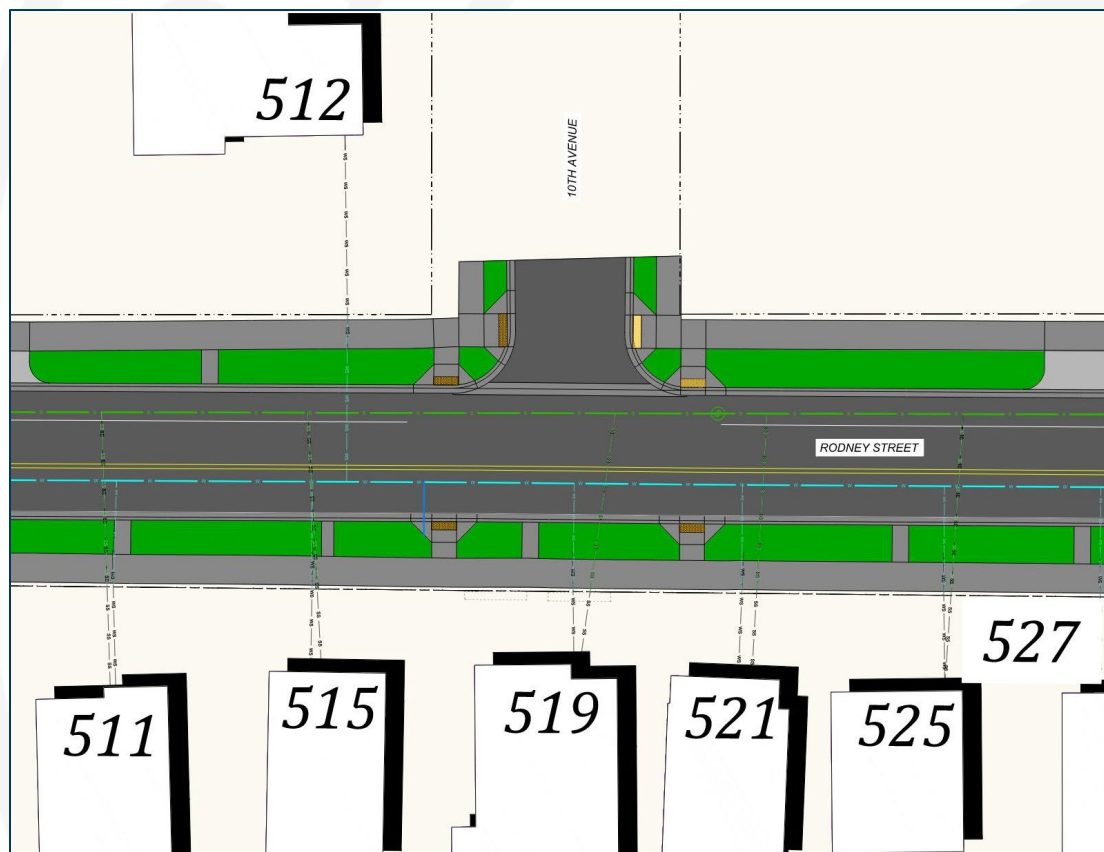

10th and Rodney Intersection

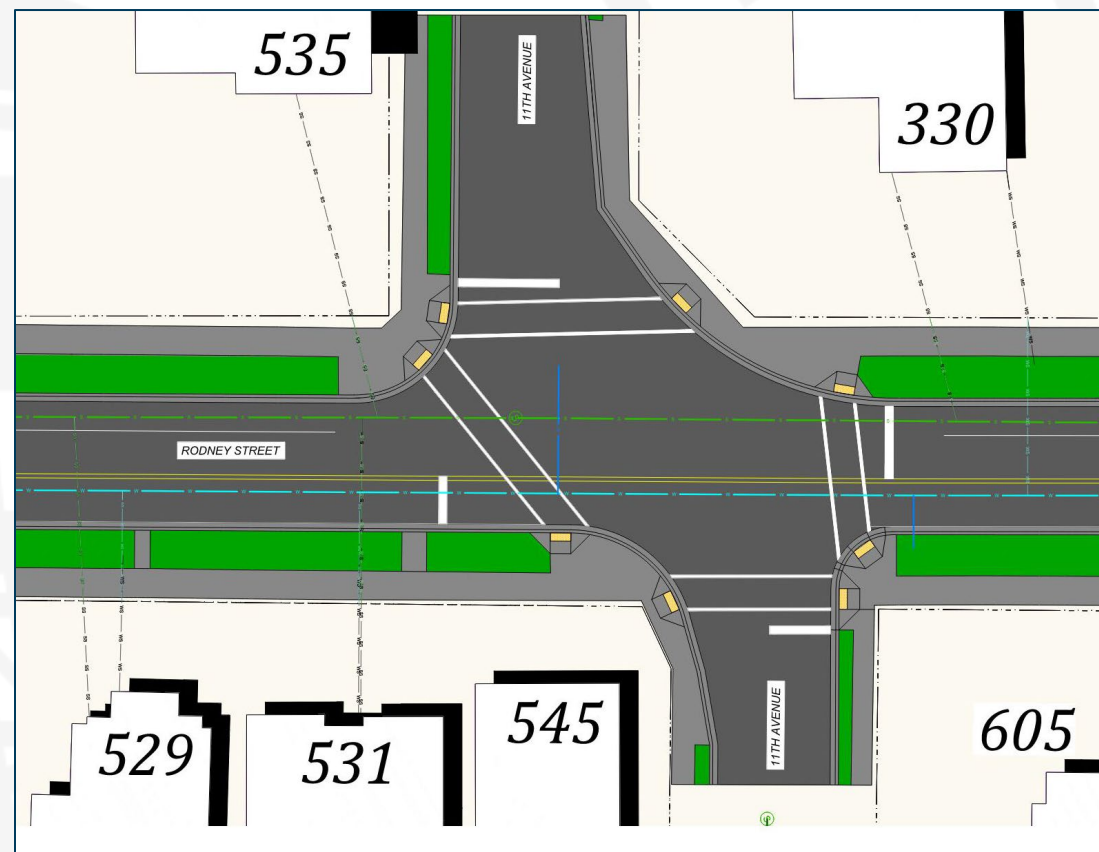

11th and Rodney Intersection

Design Plans

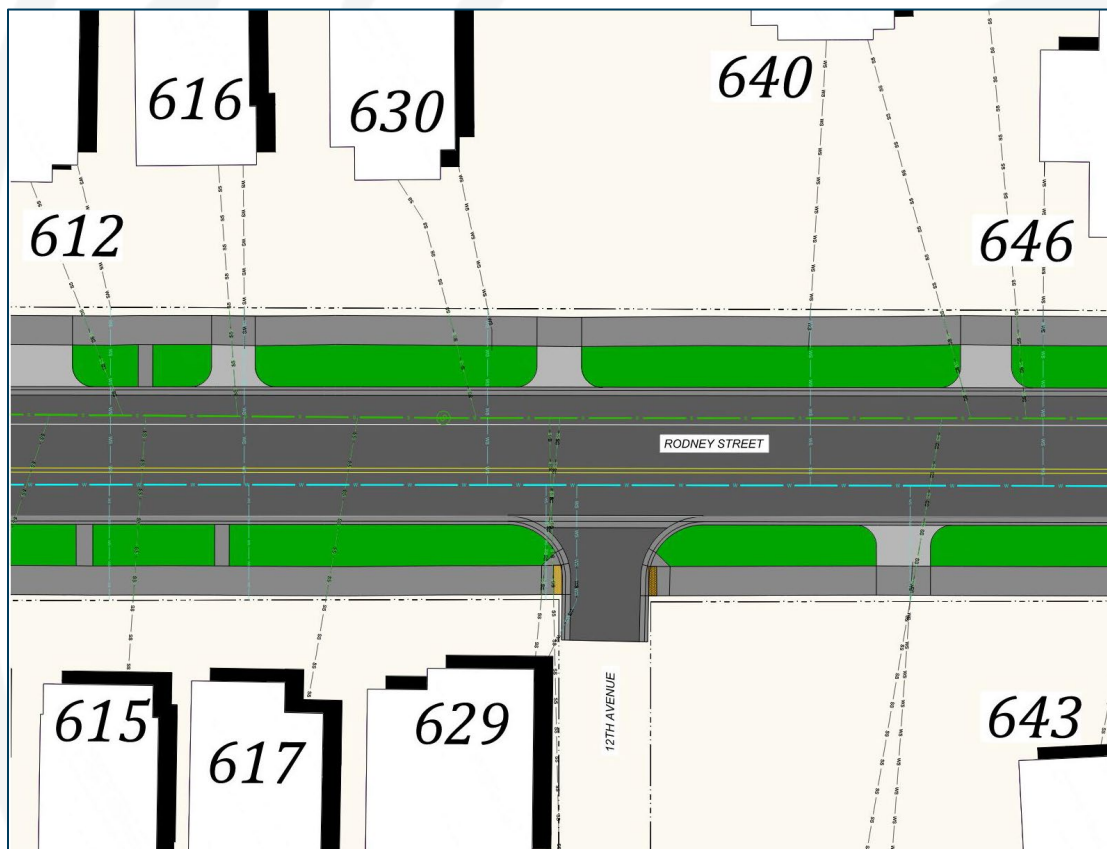

12th and Rodney Intersection

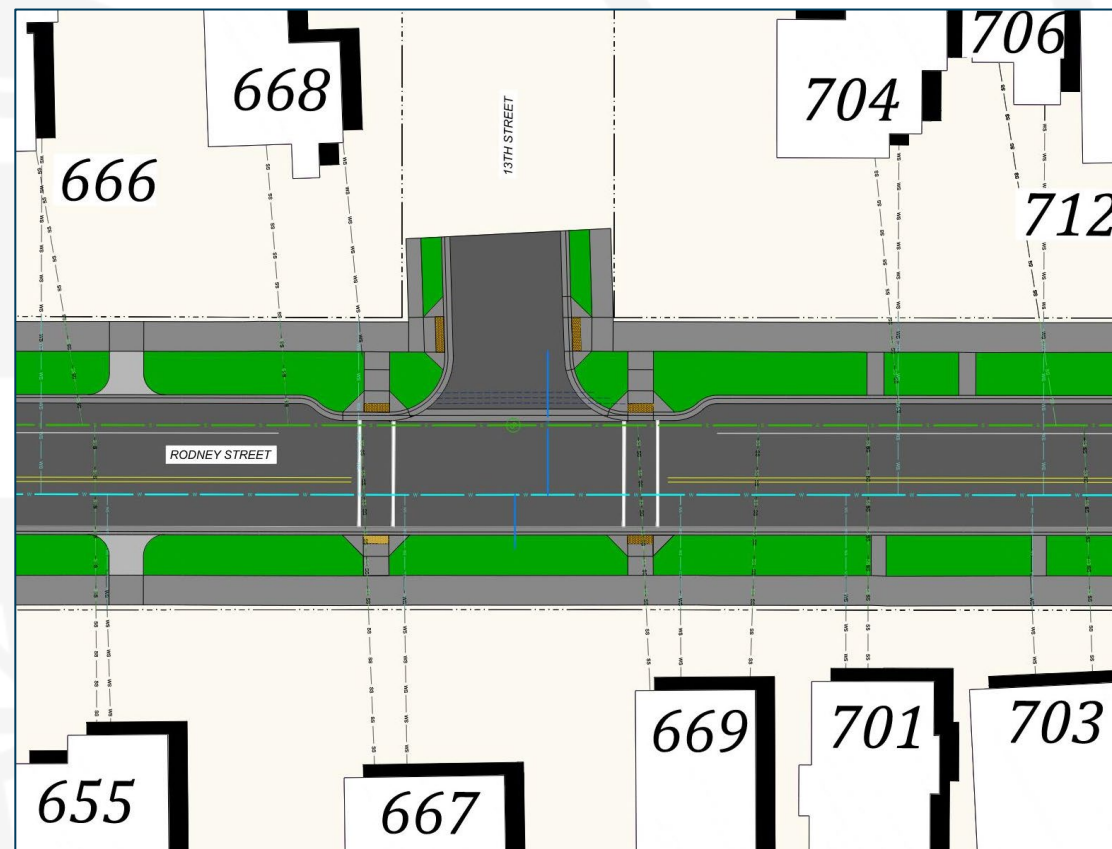

13th and Rodney Intersection

Design Plans

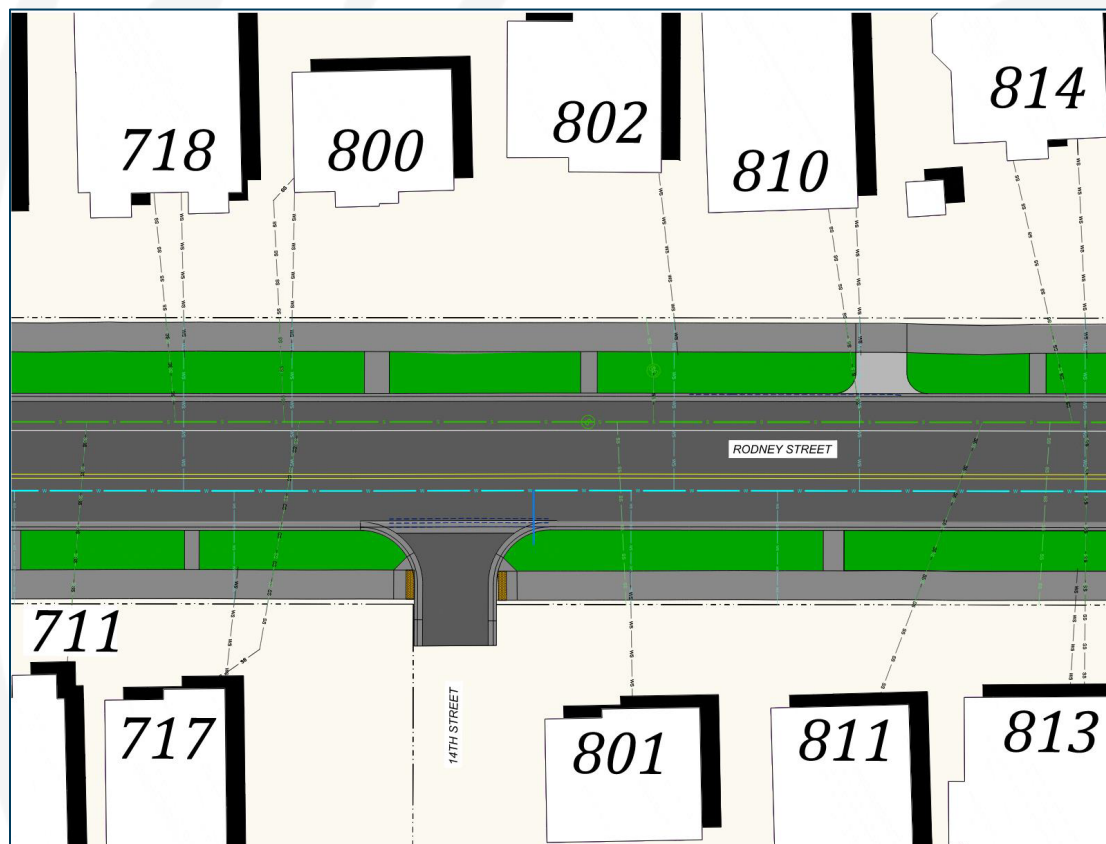

14th and Rodney Intersection

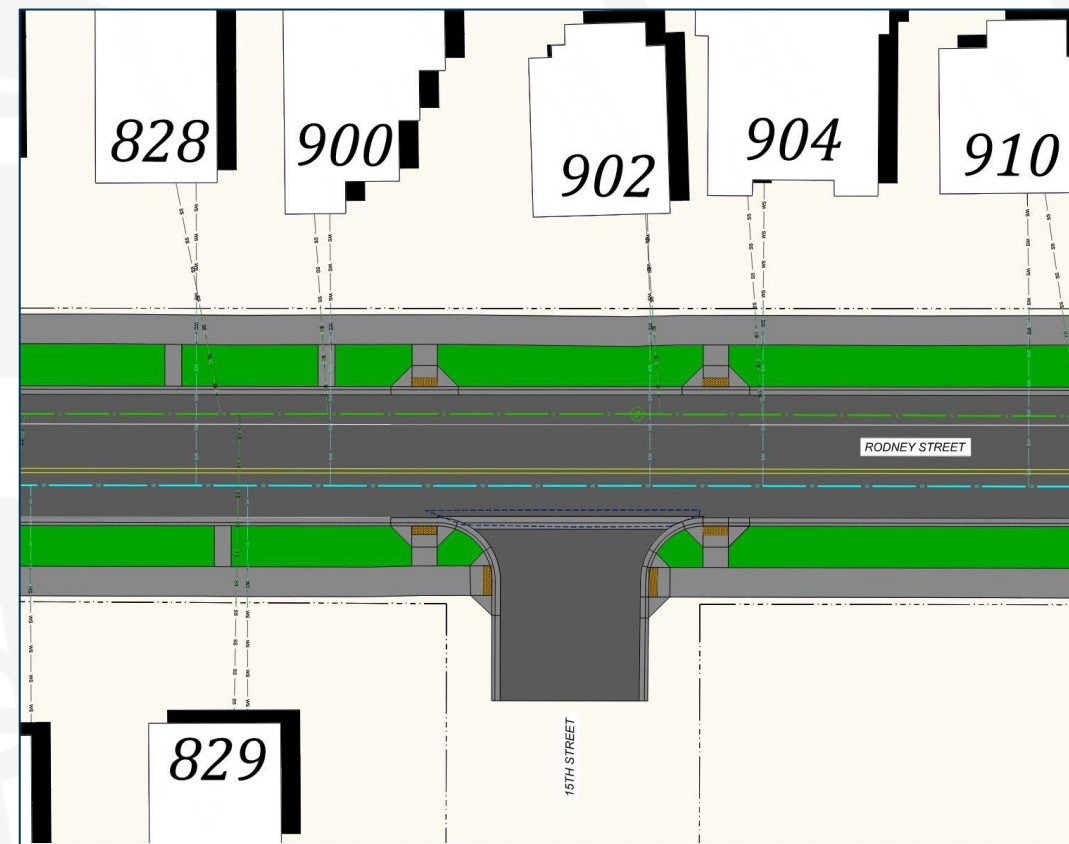

15th and Rodney Intersection

Design Plans

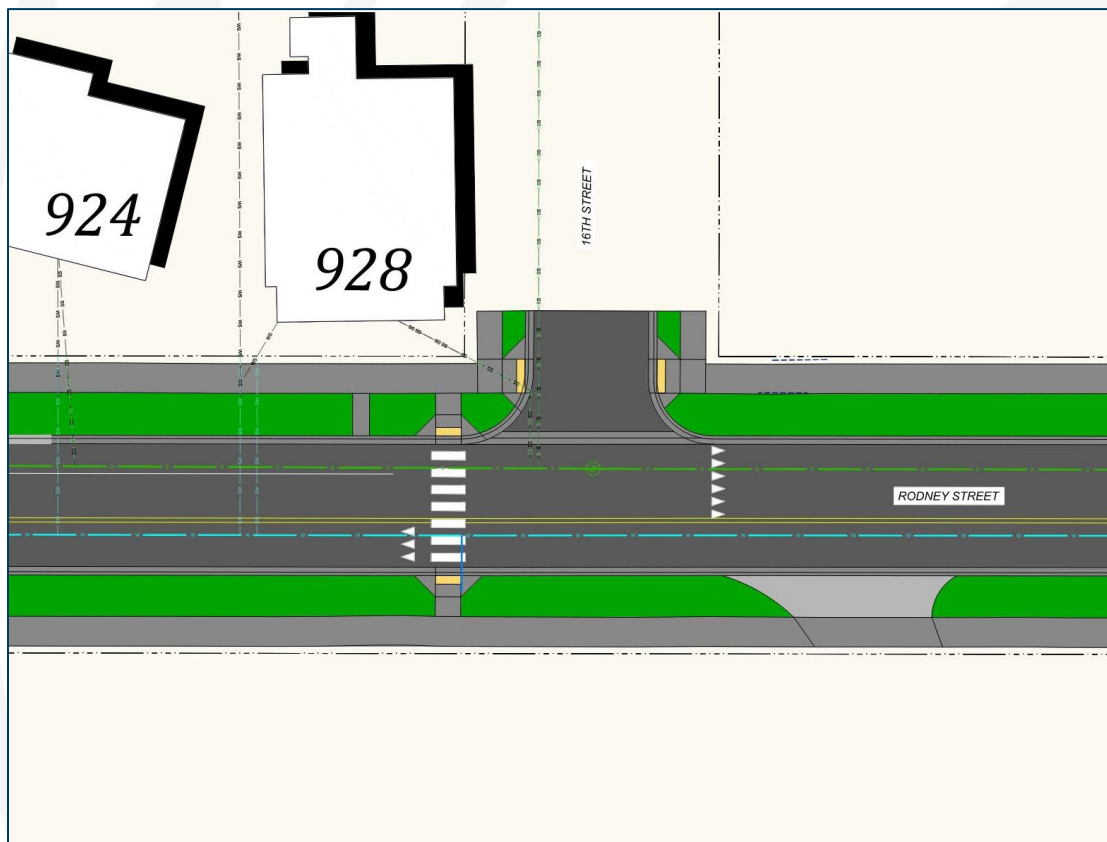

16th and Rodney Intersection

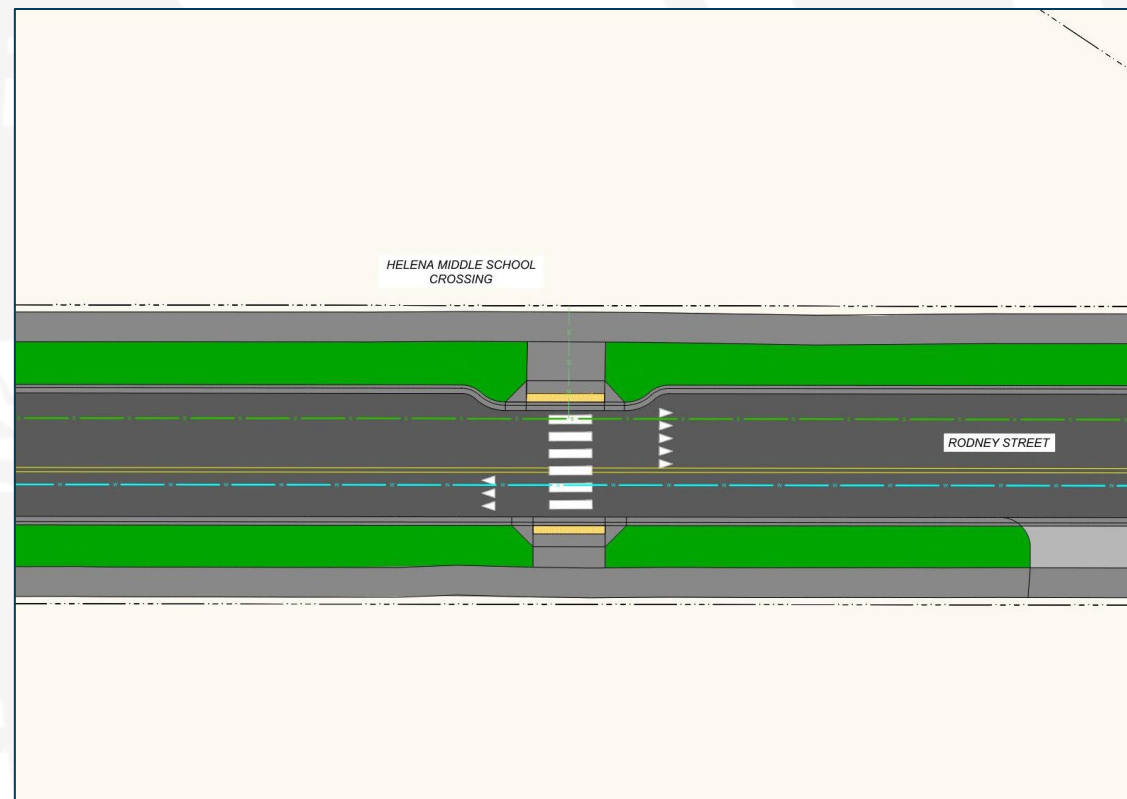

Middle School Crossing

Public Q&A Session

Questions? Comments?

➤ Raise your hand and the host will unmute your microphone.

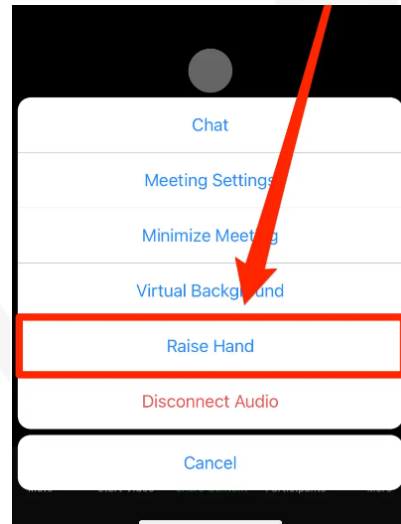
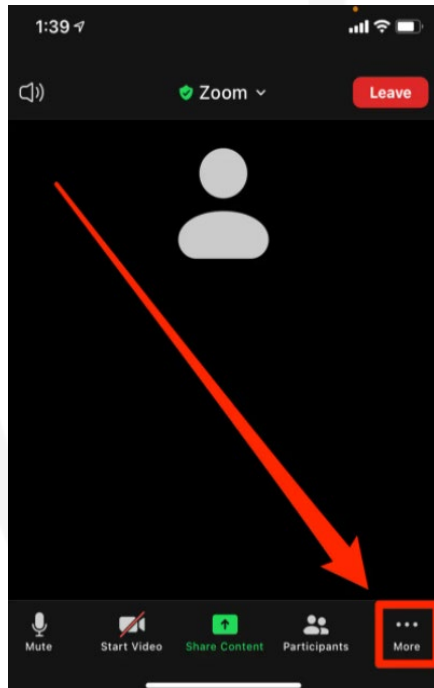

How to Stay Involved

✓ Sign up for notifications

- Text RodneySt to 47177
- Email RodneySt@kljeng.com

✓ Project Website

www.helena.mt.gov/public-works-projects

✓ Comments?

- @CityofHelena on Facebook
- Email RodneySt@kljeng.com



Thank you!

What's next?

- ✓ Additional open houses this summer.
- ✓ Project website updated as progress continues.
- ✓ Notifications of open houses on Facebook and by mail.

We're always available via email and phone

Matt Culpo, City Project Manger

✓ 406-447-8073

✓ mculpo@helenamt.gov

Or

✓ RodneySt@kljeng.com